

Iron Oak
Ride and Drive
Saturday April 23, 2011
At Castle Rock Horse Trails
Sanctioned by: **MDDA** and **UMECRA**



<u>Ride/Drive</u>	<u>Fee</u>	<u>Start Time</u>
25 mile Limited Distance LD UMECRA Sanctioned Only	\$55 SR \$30 JR	7:00 AM
25 mile Competitive	\$50 SR \$25	7:30 AM
12 mile Novice Ride	\$25 SR \$15 JR	12:30 PM
12 mile Competitive Drive	\$35	1:00 PM
6 mile Competitive Drive	\$30	1:15 PM

Original negative COGGINS required on all horses. A copy of COGGINS must be left with Ride Management.

Trails: Castle Rock Horse Trails wind along the scenic Wisconsin River in Adams County. Although this is not hilly terrain, it is a beautiful and enjoyable trail. Over 90% of the trails are two track or wider, and they often wander to the shores of the Wisconsin River.

Location/Camping: Ukarydee Campground east of Necedah, Wisconsin. Reserve your camping spot directly with Ukarydee at (608)564-2233.

Lunch will be provided by MDDA

All cats and dogs must be on a leash!

Awards: Completion awards to all who finish. Appropriate placing awards in all weight divisions.

Veterinarians: Dr Weis Elford, and Dr Mary Krempasky

Send early entries to: Jack Shea, W1975 Bakertown Drive, Sullivan, WI 53178. Please make check payable to MDDA.

Ride Management

Jack Shea
W1975 Bakertown Dr, Sullivan, WI 53178
Phone number: (262)313-7340
Email: jjsheacpa@yahoo.com

Tony Troyer
867 N 45th Rd, Earlville, IL 60518
Phone number: (815)530-4464
Email: ilaerc@aol.com

Directions: Ukarydee Campground lies southwest of Wisconsin Rapids and north of Wisconsin Dells, off HWY Z in Adams County. Take HWY 21 east out of Necedah and watch for turn signs. Turn on HWY Z going south, then take Cumberland Road to the west. Ukarydee is down the road on your left. Reserve your camping spot directly with Ukarydee: (608)564-2233.

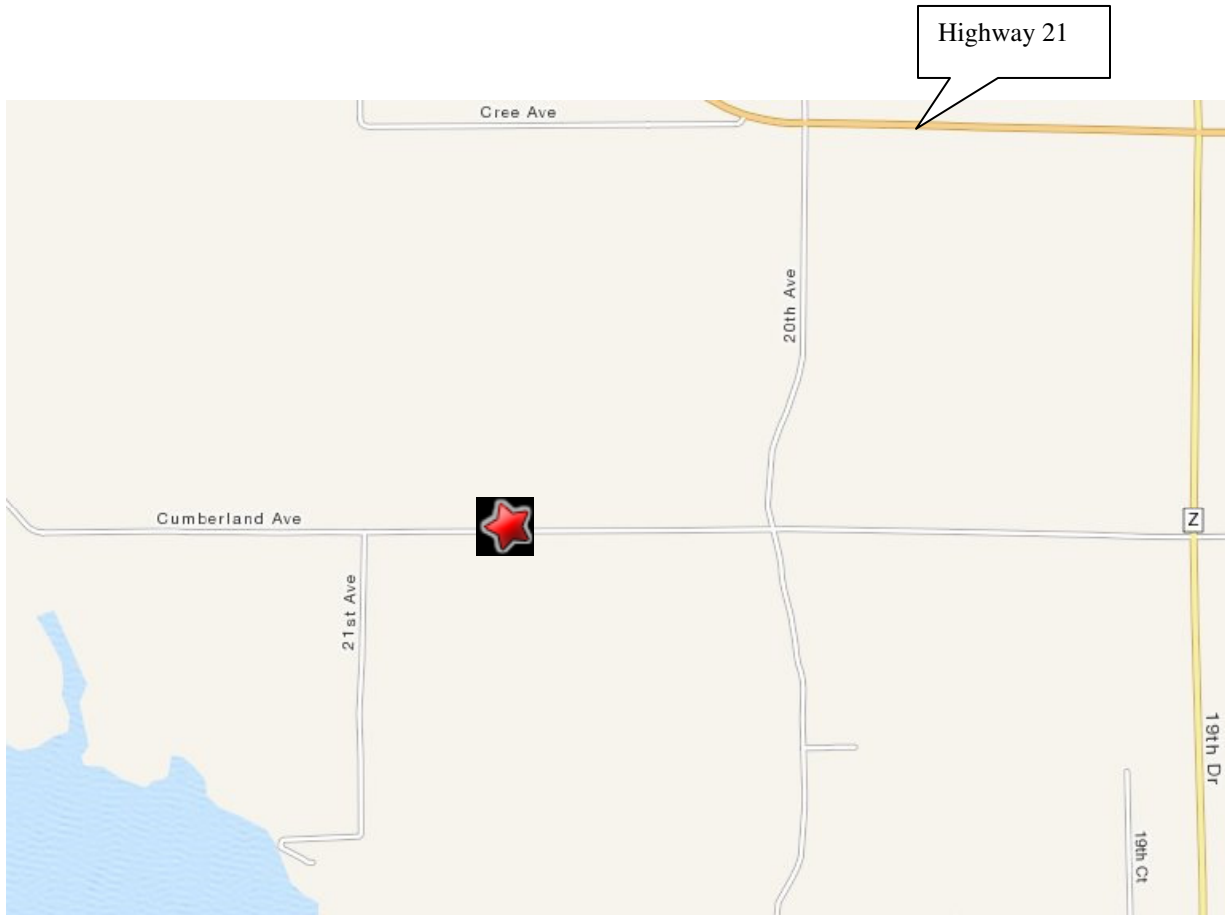

Iron Oak Early Entry Forum

Name: _____

Horse's Name: _____

Address: _____

Phone number: _____

Email address: _____

Event(s): _____

Fee(s): _____

Send early entries to: Jack Shea, W1975 Bakertown Drive, Sullivan, WI 53178. Please make check payable to MDDA.