



# MnDRA I

May 7th & 8th, 2011

SAND DUNES STATE FOREST  
 Sherburne County, MN near Orrock

Sponsored by: Minnesota Distance Riding Association

Sanctioned by: AERC...UMECRA...MnDRA...AHA

(Local AHA sanctioned 50 mile Endurance ride on Saturday, Local AHA Competitive 25 mile ride on Sunday)

**TRAIL:** Most trails are *sandy*, fairly level, with a few hills

All Checks In Camp. Horses should be traffic safe.

**ALL RIDERS WILL BE REQUIRED TO WEAR HELMETS!**

**CAMP:** DNR State Forest camping fees apply

**ALL DOGS MUST BE ON LEASH!**

Be prepared to share designated campsites

Primitive Camp

Send Pre-entries to:

Theresa Meyer

**POTLUCK SATURDAY NIGHT:**

3028 18<sup>th</sup> Ave. NW, Cedar, MN 55011

Management will supply a main dish.

Please bring a dish to pass.

763-753-5236

<u>Saturday, May 7th:</u>	<u>Start time</u>	<u>Fees</u>
50 mile endurance	6:00 a. m.	\$70.00 Sr.* \$50.00 Jr.*
25 mile Limited Distance	6:30 a. m.	\$55.00 Sr.* \$40.00 Jr.*
25 mile competitive	10:00 a. m.	\$50.00 Sr. \$35.00 Jr.

\*\$15.00 Surcharge for non-AERC members for 50 end. & LD\*

<u>Sunday, May 8th:</u>	<u>Start time</u>	<u>Fees</u>
25 mile Limited Distance	6:00 a. m.	\$55.00 Sr.* \$40.00 Jr.*
25 mile Competitive &	7:00 a. m.	\$50.00 Sr. \$35.00 Jr.
12 mile Novice Competitive	9:00 a. m.	\$25.00

**\*\*\*Copy of NEGATIVE COGGINS paper required to leave with management\*\*\***

**\*\* PENS MUST BE APPROVED BY RIDE MANAGEMENT ~ Thanks.\*\***

Sand Dunes State Forest is located  
about 8 miles west of Zimmerman and 5 miles north of Big Lake.  
For Emergency Service - Dial 911  
Sherburne County Sheriff  
Non-emergency (763)241-2522 or 1-800-433-5245

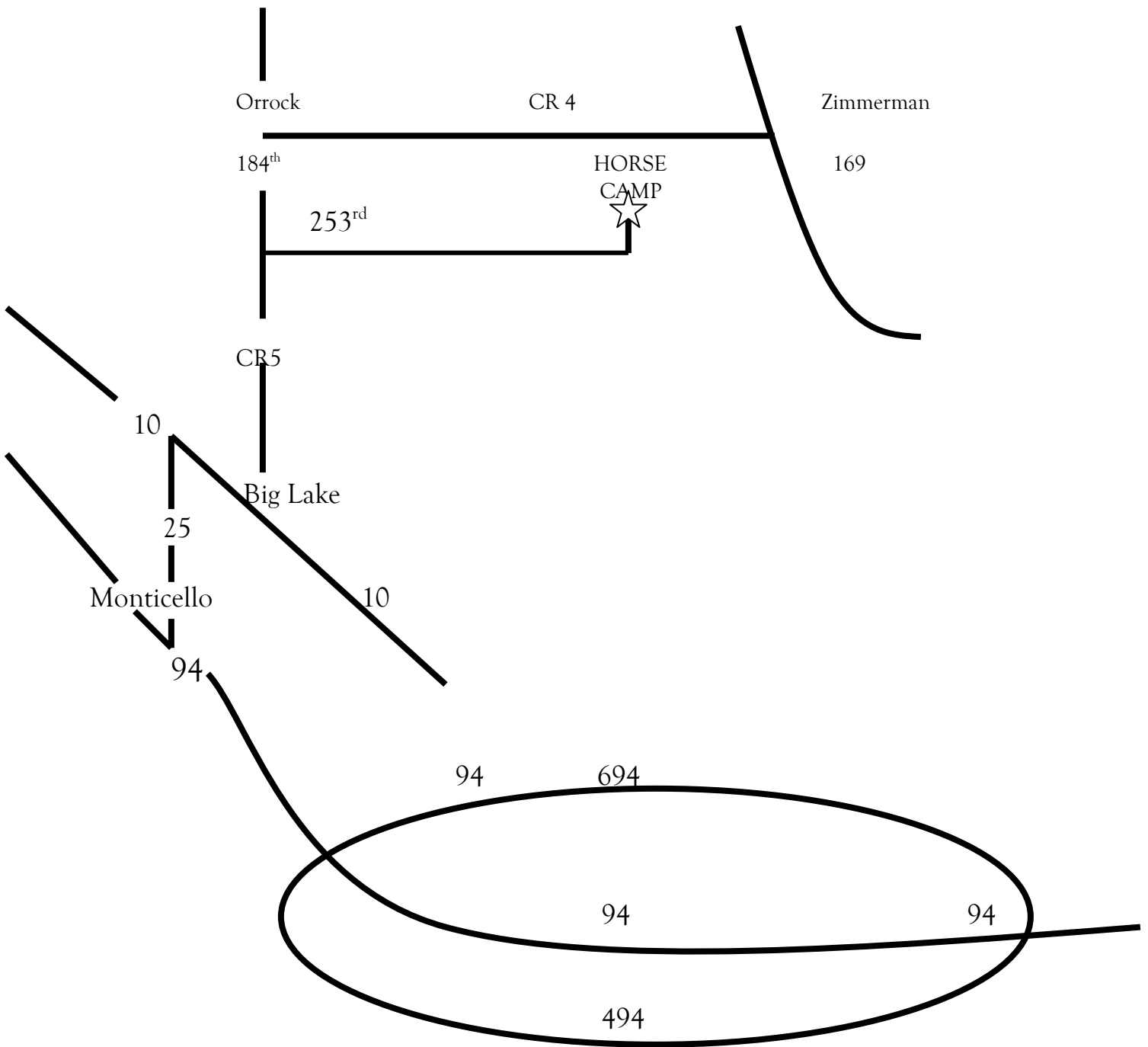

The Sand Dunes Horse Camp is reached by taking Interstate 94 to MN Hwy 25. Exit east to downtown Monticello. Continue on MN Hwy. 25 to Big Lake, and take US Hwy 10 east (turn right). About two tenths of a mile later turn left on County Road 5 North (Eagle Lake Rd. N) in Big Lake. Continue on Cty 5 to 253rd. Turn right (east), then one and half miles down the road turn left into the Horse Camp.