

**Iron Oak**  
**Ride and Drive**  
**October 13<sup>th</sup> and 14<sup>th</sup> 2012**  
Sanctioned by: AERC, MDDA, DRAW and  
UMECRA



**NEW!**

- Fall date
- AERC sanctioning

Camping at Ukarydee Campground near Arkdale, WI on the Castle Rock Horse Trail System. Reserve your camping spot directly with Ukarydee (608)564-2233

<u>Ride/Drive</u>	<u>Fee</u>	<u>Saturday</u>	<u>Sunday</u>
50 mile Endurance**	\$65 SR \$40 JR	7:15 AM	
25 mile Limited Distance**	\$50 SR \$25 JR	7:00 AM	7:00 AM
25 mile Competitive	\$45 SR \$20 JR	8:00 AM	7:30 AM
12 mile Novice Ride	\$25 SR \$15 JR	9:15 AM	8:30 AM
12 mile Competitive Drive	\$30	11:30 AM	8:45 AM
25 mile Competitive Drive	\$40	9:00 AM	8:15 AM

**\*\* \$15 surcharge for non-AERC members**

**Original negative COGGINS required on all horses. A copy of COGGINS must be left with Ride Management.**

**All dogs must be on a leash!**

**POTLUCK** on Saturday Evening, please bring a dish to pass. Ride Management will furnish main dish.

**AWARDS:** Completion awards to all who finish. Appropriate placing awards in all weight divisions.

Send early entries to: Jack Shea, W1975 Bakertown Drive, Sullivan, WI 53178. Please make check payable to MDDA.

**Ride Management**

Jack Shea  
W1975 Bakertown Drive, Sullivan, WI 53178  
Phone number: (262)313-7340  
Email: [jjsheacpa@yahoo.com](mailto:jjsheacpa@yahoo.com)

Tony Troyer  
867 N 45<sup>th</sup> Rd, Earlville, IL 60518  
Phone number: (815)530-4464  
Email: [il4aerc@aol.com](mailto:il4aerc@aol.com)

**Location:** Ukarydee Campground lies southwest of Wisconsin Rapids and north of Wisconsin Dells, off HWY Z in Adams County. Take HWY 21 east out of Neceeda and watch for turn signs. Turn on HWY Z going south, then take Cumberland Road to the west. Ukarydee is down the road on your left. Reserve your camping spot directly with Ukarydee: (608)564-2233.

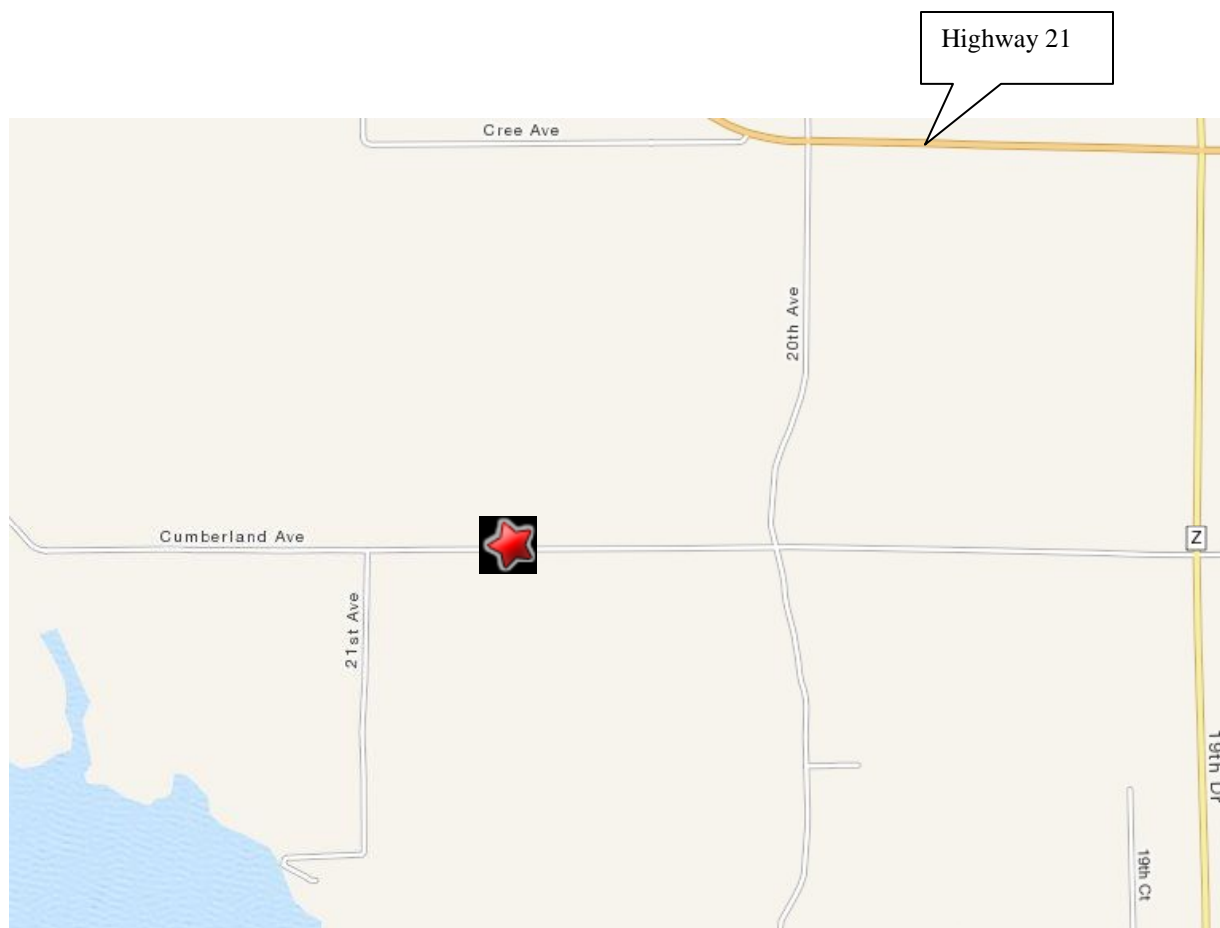

---

## Iron Oak Early Entry Form

Name: \_\_\_\_\_

Horse's Name: \_\_\_\_\_

Address: \_\_\_\_\_

Phone number: \_\_\_\_\_

Email address: \_\_\_\_\_

Event(s): \_\_\_\_\_

Fee(s): \_\_\_\_\_

Send early entries to: Jack Shea, W1975 Bakertown Drive, Sullivan, WI 53178. Please make check payable to MDDA.